

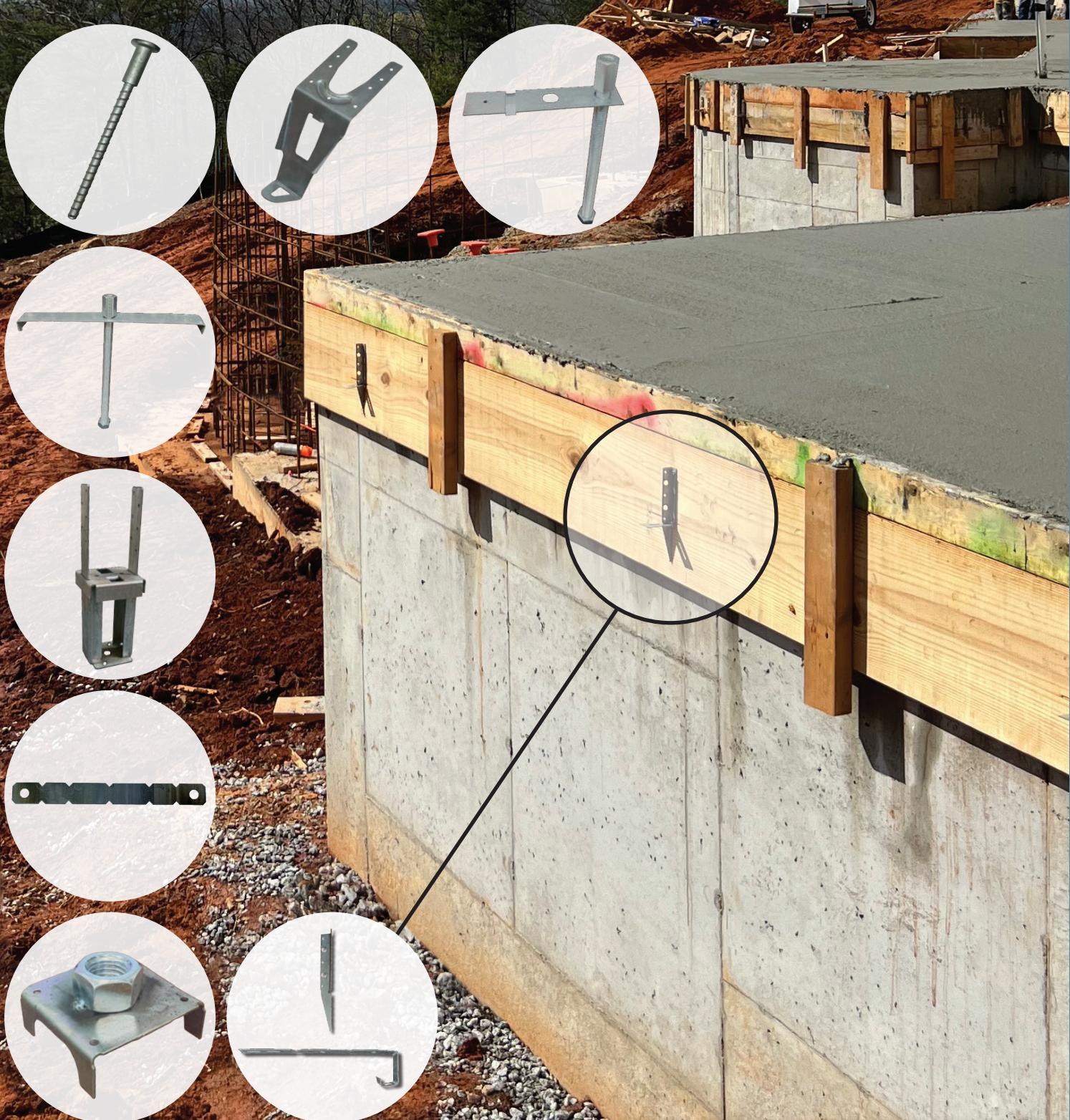

“Stronger in the Storm”™

QuickTie™ Masonry Connectors

DIVISION 3 AND 4



Parts not proportional or to scale.



Main Office: 13300 Vantage Way | Jacksonville, FL 32218 | (904) 281-0525 | To Order: orders@quicktieproducts.com | quicktie.com

QUICK TIE PRODUCTS, INC. | PRODUCT CATALOG | SPRING 2026

PRODUCT	PAGE NO.	PRODUCT	PAGE NO.	PRODUCT	PAGE NO.
FOUNDATION CONNECTORS		Anchor Bolt	7	Post Bases	
SPArTan® Sill Plate Anchor	3	Anchor Bolt Assembly	7	Porch Post Base Anchors	New 10
Form Ties & Form Wedge	New 5	Foundation Anchor Strap (FASA)	New 8	Purlin Anchor Straps	
Wall Ties	New 6	Epoxy Anchors	8	PAS Series	10
CMU Saddle Assembly	6	QuickTie™ Epoxy	9	METAS/HETAS Series	11
Anchor Chair	7	Foundation Strap-Tie Holdowns	9		

QuickTie™ Product Index

Below is the QuickTie™ product index, noting product categories, QuickTie™ part numbers, catalog page numbers, and certain “Reference Numbers”.

These Reference Numbers are for the purpose of enabling our customers to identify the QuickTie™ alternative to specified product names, but the attributes of the products references (particularly load values) may differ from the QuickTie™ part.

Please note that product comparison via Reference Numbers is for general application comparison only. Reference Numbers should not be used as an apples-to-apples substitution tool. Customers are solely responsible for comparing specific load values, fastener schedules, anchoring requirements, material specifications, and other factors when determining the suitability of use of any particular product. QuickTie™ makes no claim, stated or implied, of suitability for purpose or qualification for usage of our products that may be substituted for a specified product. Any specification, submittal, or change to a specified product should be approved in writing by the designer or Engineer of Record (EOR).

MiTek® and Simpson Strong-Tie® are registered trademarks of their respective companies, with which QuickTie™ is unaffiliated, and neither of whom endorse or approve use of their product names in this catalog as “reference numbers”.

QT Products	QT	Reference Numbers		Page
		Simpson® Hardware (SH)	MiTek® Hardware (MH)	
Foundation Connectors				
SPArTan Sill Plate Anchor	SPA67	THD	PFM	3
Form Tie/Form Wedge	FT8, FT6, FT6S & FTW	-	-	5
Wall Ties	WT10	-	-	6
	WT6-8	-	-	
CMU Saddle Assembly	CMUB	-	-	6
	CMUG			
	CMUO			
	CMUR			
Anchor Chair	AC33	ABL	ARC	7
Anchor Bolt	ABG	PAB	AB	
	ABO	SB		
	ABR	-		
Anchor Bolt Assembly	QTABA	AM	-	7
Foundation Anchor Strap	FASA4	MASA, MASAZ	FA4, FA4-TZ	8
Epoxy Anchors	EA	THD	PFM	8
Epoxy	QE-1	SET-3G	CIA-GEL 7000-C	9
		SET-XP	CIA-GEL 7000	
		ET-HP	-	
		SET	-	
		AT-XP	-	

QT Products	QT	Reference Numbers		Page
		Simpson® Hardware (SH)	MiTek® Hardware (MH)	
Foundation Connectors, Cont.				
Foundation Strap-Tie Holdowns	FSTHD8	LSTHD8	LSTAD8	9
	FSTHD8J	LSTHD8J	LSTAD8RJ	
	FSTHD10	STHD10	STAD10	
	FSTHD10J	STHD10RJ	STAD10RJ	
	FSTHD14	STHD14	STAD14	
Porch Post Bases	FSTHD14J	STHD14RJ	STAD14RJ	10
	PBA44-4P	PPB44-4Z	-	
	PBA44-6P	PPB44-6Z	-	
	PBA66-4P	PPB66-4Z	-	
Purlin Anchor Straps	PBA66-6P	PPB66-6Z	-	10
	PAS18-3Z	PA18, PA18Z	PA18, PA18-TZ	
	PAS23-3Z	PA23, PA23Z	PA23, PA23-TZ	
	PAS28-3Z	PA28, PA28Z	PA28, PA28-TZ	
Embedded Truss Straps	PAS35-3Z	PA35, PA35Z	PA35	11
	PAS51-3Z	PA51, PA51Z	TA51, TA51-TZ	
	METAS12-3Z	META12	HTA16-18	
	METAS16-3Z	META16	HTA16-18	
	METAS18-3Z	META18	HTA20-18	
	METAS20-3Z	META20, META20Z	HTA20-18, HTA20-TZ	
	METAS24-3Z	META24	HTA24-18	
	METAS40-3Z	META40	HTA48	
	HETAS12-3Z	HETA12	HTA12	
	HETAS16-3Z	HETA16	HTA16	
	HETAS20-3Z	HETA20, HETA20Z	HTA20, HTA20-TZ	
HETAS24-3Z	HETA24	HTA24		
HETAS40-3Z	HETA40	HTA48		

SPArtan[®] SILL PLATE ANCHOR

(U.S. PATENT NO. 11,236,775)

The Most Efficient
and Cost Effective
Sill Plate Anchor
on the Market!



KEY ADVANTAGES OF SPArtan[®] ANCHORS:

- **Less Expensive** - Saves money and time on each job. Needs only one drill bit. Built in washer eliminates assembly.
- **Stronger** - Requires fewer anchors compared to traditional anchors. Less disturbance to the concrete.
- **Faster and Easier To Install** - No epoxy and no washer required. Easy and quick to screw in concrete. No need to change bits.
- **Geomet[®] Finish** - Coated with Geomet [superior to hot-dip galvanizing (HDG)] for permanent exterior and corrosive environments.



SPArtan[®] Installation Video

Quick Tie Products, Inc.
quicktie.com

MAIN OFFICE:
13300 Vantage Way
Jacksonville, FL 32218
Phone: (904) 281-0525
info@quicktieproducts.com

SPArtan® SILL PLATE ANCHOR (U.S. PATENT NO. 11,236,775)

PRODUCT FEATURES:

SPArtan® Sill Plate Anchors are post-installed anchors used to attach the sill plate of a wood framed wall to a concrete foundation/curb and rim boards to concrete/CMU walls. SPArtan® anchors are made from carbon steel wire and have a smooth shank shoulder (5/8" diameter x 1-1/2" long) at the top for sill plate and rim board attachments. This transitions into a threaded shank (3/8" diameter x 6" long) for concrete foundation/curb and concrete/CMU wall attachments. The head is comprised of a 1-1/4" diameter flange and a 3/8" square recess for easy anchor installation. SPArtan® anchors are designed to resist shear and tension loads due to wind and seismic forces in cracked and uncracked concrete.

MATERIAL:

Hardened Carbon steel

COATING:

GEOMET®, Superior to HDG

INSTALLATION:

See below

CODE COMPLIANCE:

TER 0910-01, FL 3557

PART NO.	CARTON QTY.
SPA67-100DB	100 SPArtan®, 1 SPArtan® Drill Bit
SPA67-100	100 SPArtan®
SPA67-50	50 SPArtan®
DBMSPA67	1 SPArtan® Drill Bit

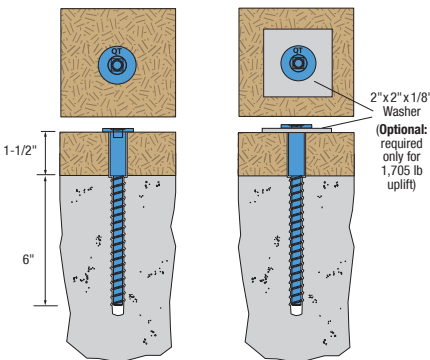

SPArtan® ANCHOR ALLOWABLE SHEAR VALUES (ASD)

Applied Load	Allowable Loads (LB) ¹⁻⁶	
	Load Direction	Slab/Curb ⁷
Shear	Parallel to Wood Grain (F ₁)	1,395
	Perpendicular to Wood Grain (F ₂)	665
Tension	Uplift (U)	1,155
	Uplift (U) with Washer ⁸	1,705

NOTES:

- Tabulated values are applicable to uncracked concrete and pressure treated Southern Pine #2 Lumber.
- Allowable load values are determined using a conversion factor (ASD) of 1.6. The conversion factor is based on the controlling load case: $(0.9D + W) / (0.6D + 0.6W)$, where Dead Load (D) = 30% and Wind Load (W) = 70%. Adjustments shall be made where other load combinations control.
- Anchor design conforms to ACI 318 with no supplementary reinforcement considered.
- Anchor bending yield strength, $F_{yb} = 100,000$ psi and concrete dowel bearing strength, $F_e = 7,500$ psi.
- Allowable loads are provided for a 1.6 load duration (C_D). No further increases are permitted.
- Allowable loads use a wet service factor $C_M = 0.7$ (M.C. > 19%). No further reduction required.
- Minimum Requirements: Edge distance = 2.25 inches, End distance = 6 inches, Spacing = 6.75 inches, Embedment depth = 6 inches, Curb width = 6 inches, Slab/Curb depth = 9 inches and Concrete compressive strength = 2,500 psi.
- Washer size is 2 inch x 2 inch x 1/8 inch.

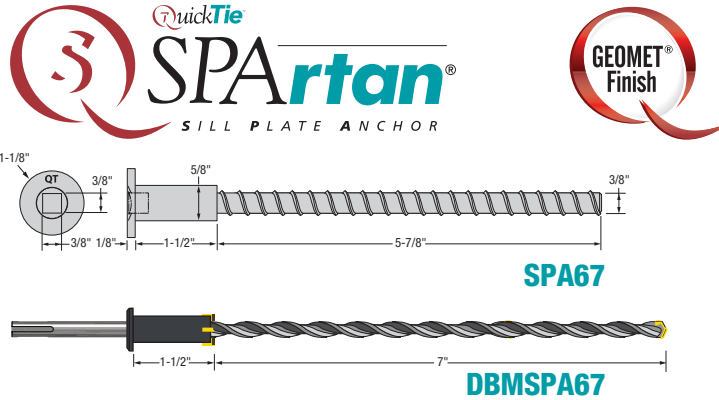

CAUTION: Use of the SPArtan® Drill Bit is recommended. Oversizing of holes drilled in either the wood sill plate or concrete will reduce the load capacity of the anchor. The SPArtan® Drill bit is a proprietary, carbide-tipped step bit, custom designed for the installation of the SPArtan® anchors.

SPArtan® ANCHOR SPACING EQUIVALENTS TO EPOXY ANCHOR

Epoxy Anchor Size	Epoxy Anchor Spacing					
	16"	24"	32"	36"	40"	48"
	Equivalent SPArtan® Anchor Spacing (in.)					
1/2"	30	45	61	68	76	91
5/8"	21	32	42	48	53	64

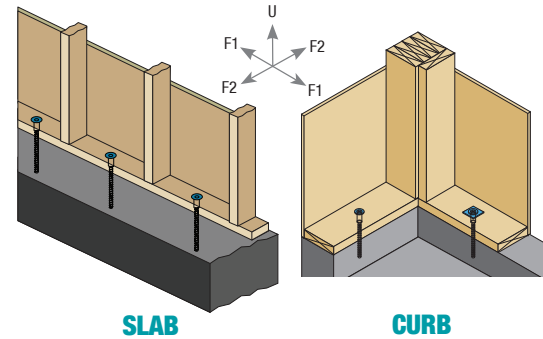

NOTES:

- Tabulated values are based on the lateral resistance of sill plate (SP #2, PT) connection when loaded parallel to grain.
- Minimum requirements: Threaded rod length = 6"; Embedment depth = 3.5"; Edge distance = 2.25", End distance = 6"; Concrete compressive strength = 2,500 psi and Sill plate thickness = 1.5".
- Engineer-of-Record (EOR) to check anchor spacing limits for out-of-plane bending and deflection of sill plate.

INSTALLATION INSTRUCTIONS

- Clean the top surface of sill plate and mark the SPArtan® anchor location(s).
- Use a rotary hammer drill and SPArtan® stepped drill bit (sold by Quick Tie Products, Inc.) to drill a hole in the sill plate. Stop and remove wood dust as necessary.
- Once the drill bit hits concrete, take precaution not to overwork the drill and/or drill bit. Intermittently, stop and clean concrete dust from the hole. If necessary, use compressed air (or other means) to remove debris around hole. Stop drilling when the wood bit stopper hits the top surface of sill plate. Over drilling may damage the carbide tips of wood bit.
- Install SPArtan® anchor using an impact drill with 3/8" square drive bit. Stop once the anchor flange hits the top surface of sill plate.

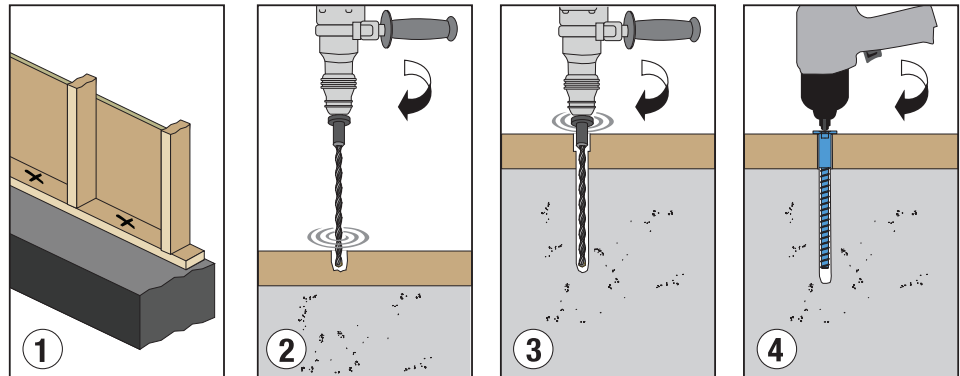

CAUTION: APPROPRIATE PERSONAL PROTECTIVE EQUIPMENT (PPE) MUST ALWAYS BE WORN

Concrete and Masonry Anchors

FORM TIES (FT8 & FT6), FORM TIE - SHOT (FT6S) AND FORM TIE WEDGE (FTW) (U.S. PATENT NO. 9,834,945)

PRODUCT FEATURES:

Form Tie (FT8 & FT6), Form Tie-Shot (FT6S) and Form Wedge (FTW) anchors provide easy installation for the foundation contractor or framer. They can be used in either stem walls or slabs. They are easily attached to the form prior to placement of concrete.

MATERIAL:

FT8, FT6, FT6S - 16 gauge

FTW - 12 gauge

COATING:

Galvanized

INSTALLATION:

PART NO.	CARTON QTY.
FT8	72
FT6, FT6S	100
FTW	100

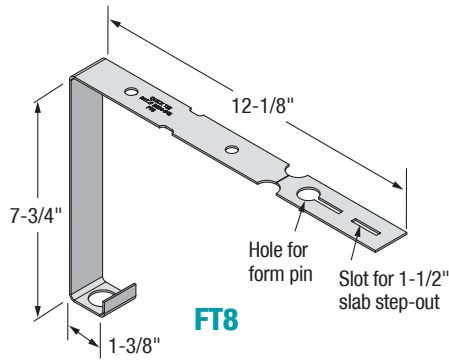

FT8

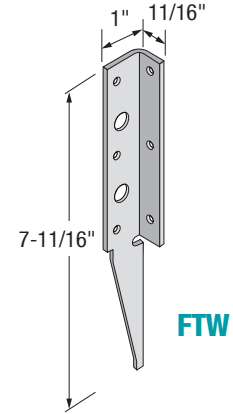

FTW

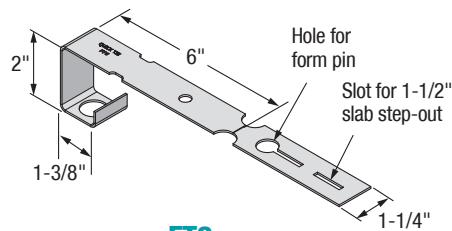

FT6

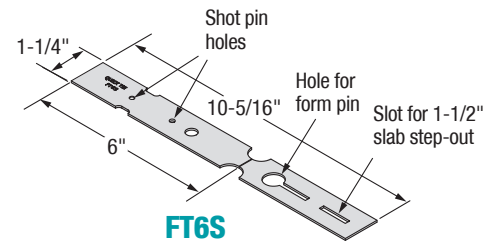

FT6S

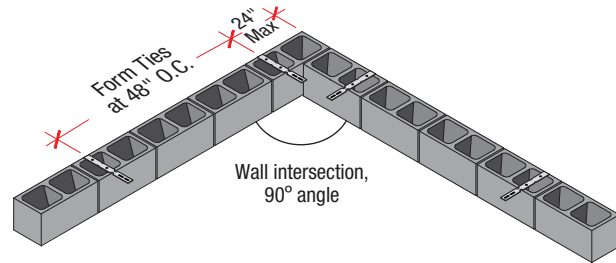

Wall intersection, 90° angle

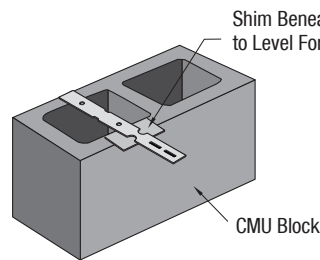

Shim Beneath Form Tie to Level Form as Needed

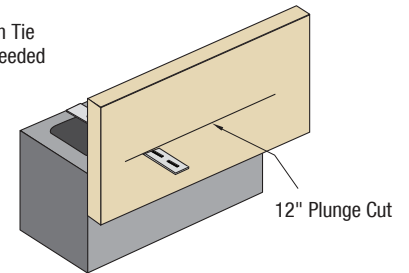

12" Plunge Cut

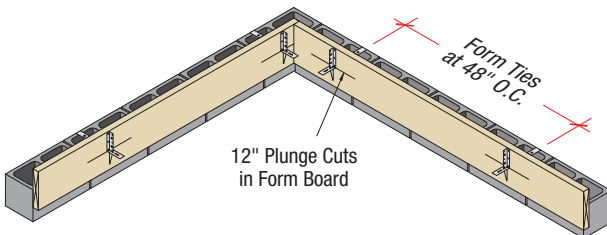

12" Plunge Cuts in Form Board

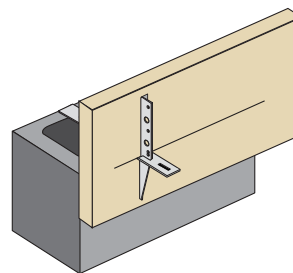

Eliminates most, if not all, bracing

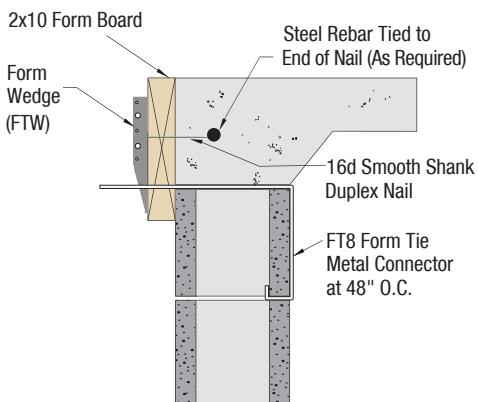

CMU Stem Wall - Edge of Slab

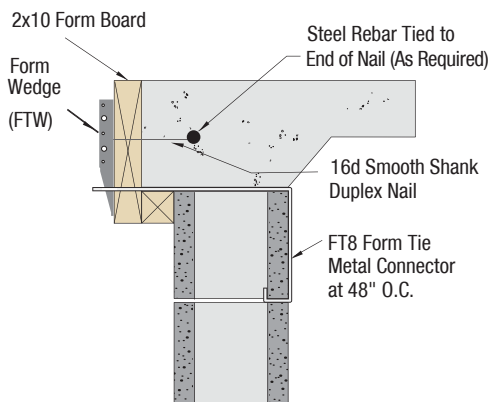

CMU Stem Wall - Extended Edge of Slab

Concrete and Masonry Anchors



WALL TIES (WT)

PRODUCT FEATURES:

QuickTie™ Wall Ties (WT6, WT8 & WT10) are designed to make concrete wall construction easier, faster, and more reliable. Made from high-strength Grade 80 steel, they help maintain consistent wall thickness, hold the formwork in place, and resist concrete pressure throughout the pouring and curing process.

MATERIAL:

WT - 14 Gauge

COATING:

None

FAILURE LOAD:

7,200 lb.

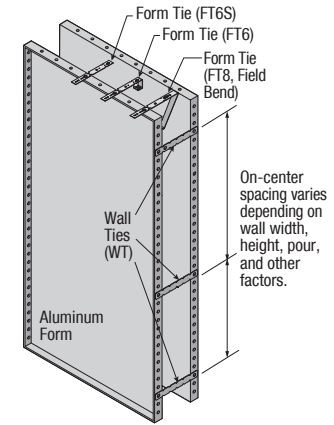
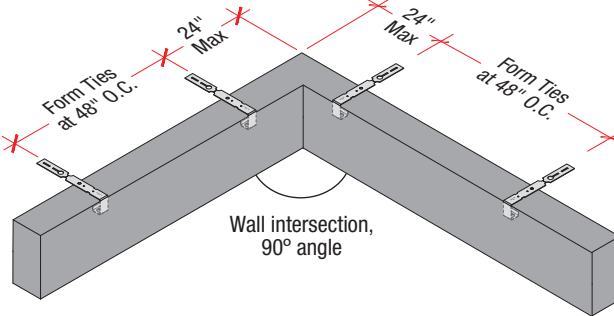
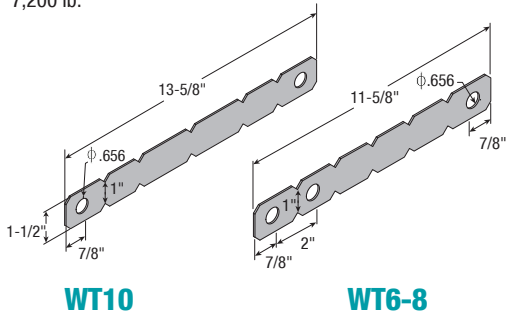
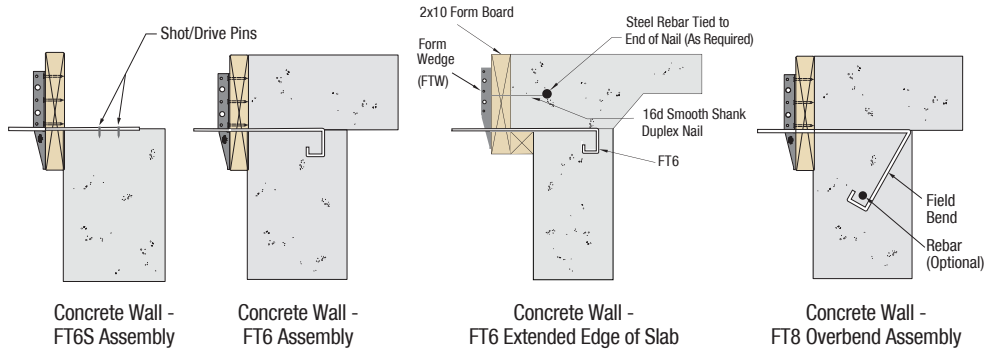

CONCRETE WALL WITH FORM TIES (FT8, FT6 & FT6S)

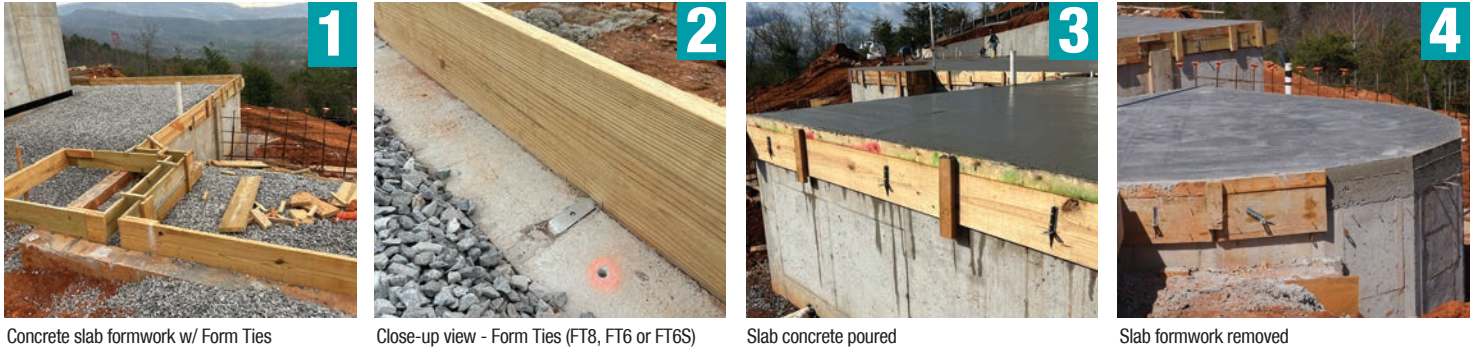

CMU SADDLE ASSEMBLY

PRODUCT FEATURES:

The CMU Saddle Assembly is designed to allow for easy installation and placement of Anchor Bolts when used with QuickTie™ Cables in concrete masonry wall applications. The CMU Saddle Assembly comes in eight different sizes to cover the four QuickTie™ sizes and 8" and 12" wide masonry walls. Each CMU Saddle Assembly includes saddle strap, anchor bolt and coupling.

ASSEMBLY:

Saddle Strap - 20 Gauge, Galvanized (G90)

Anchor Bolt - ASTM A36 Steel, Zinc Plated

Couplers - Grade 2, Zinc Plated

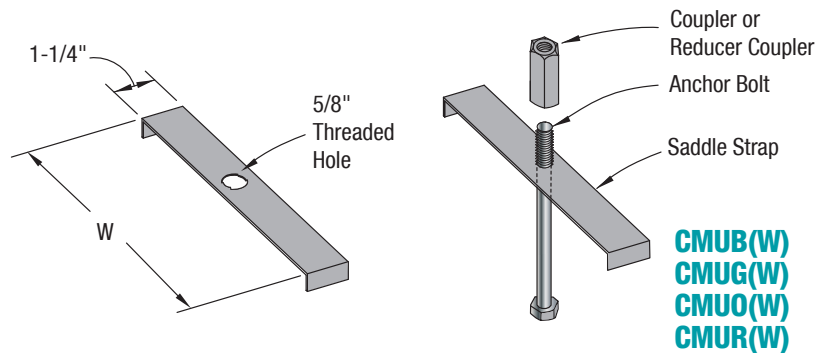

Part No.	Width (W)	Description
CMUB8	7-5/8"	8" CMU Wall, 20 Ga. Strap, 5/8" Anchor Bolt & Reducer Coupler
CMUB12	11-5/8"	12" CMU Wall, 20 Ga. Strap, 5/8" Anchor Bolt & Reducer Coupler
CMUG8	7-5/8"	8" CMU Wall, 20 Ga. Strap, 5/8" Anchor Bolt & Reducer Coupler
CMUG12	11-5/8"	12" CMU Wall, 20 Ga. Strap, 5/8" Anchor Bolt & Reducer Coupler
CMUO8	7-5/8"	8" CMU Wall, 20 Ga. Strap, 5/8" Anchor Bolt & Coupler
CMUO12	11-5/8"	12" CMU Wall, 20 Ga. Strap, 5/8" Anchor Bolt & Coupler
CMUR8	7-5/8"	8" CMU Wall, 20 Ga. Strap, 5/8" Anchor Bolt & Reducer Coupler
CMUR12	11-5/8"	12" CMU Wall, 20 Ga. Strap, 5/8" Anchor Bolt & Reducer Coupler

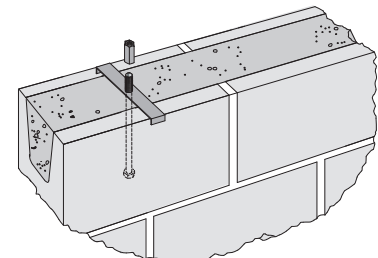

Concrete and Masonry Anchors

ANCHOR CHAIR (AC33)

PRODUCT FEATURES:

Anchor Chair (AC33) is utilized for the precise and easy placement of wet set/cast-in-place anchor rods in elevated slabs.

MATERIAL:

16 gauge

COATING:

None

INSTALLATION:

- Align nail holes over chalk line and nail to form.
- Install desired size anchor rod to AC33.

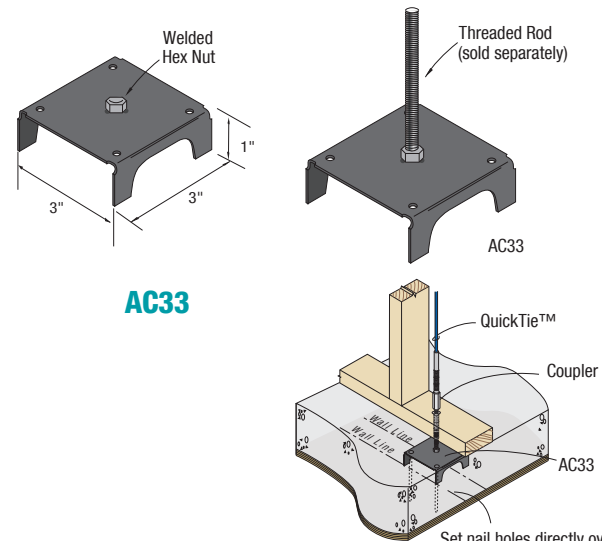

AC33

Part No.	Description
AC33.37	Anchor Chair with 3/8" Welded Hex Nut
AC33.5	Anchor Chair with 1/2" Welded Hex Nut
AC33.62	Anchor Chair with 5/8" Welded Hex Nut
AC33.75	Anchor Chair with 3/4" Welded Hex Nut
AC33.87	Anchor Chair with 7/8" Welded Hex Nut
AC33.1.0	Anchor Chair with 1" Welded Hex Nut
AC33.1.12	Anchor Chair with 1-1/8" Welded Hex Nut
AC33.1.25	Anchor Chair with 1-1/4" Welded Hex Nut

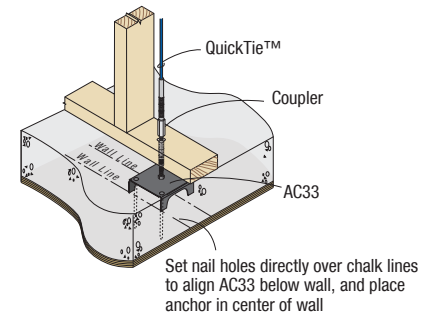

ANCHOR BOLT

PRODUCT FEATURES:

Anchor bolts [ABG(L), ABO(L) & ABR(L)] are cast-in-place foundation anchors used to resist high wind uplift when assembled using QuickTie™ Couplers and QuickTie™ Cables (QTG, QTO & QTR).

Anchor bolts in bent forms are available for the applications where edge distance cannot be met.

ASSEMBLY:

Threaded Rod - ASTM A36 Steel, Zinc Plated

Hex Nut - Grade 2, Zinc Plated

Square Washer - ASTM A653 Grade 33 Steel, Galvanized

(G90); ASTM A36 Steel, None or Zinc Plated

Coupler - Grade 2, Zinc Plated

INSTALLATION:

- Concrete should be a minimum of 2,500 psi.
- Install anchor bolt at required edge distance and embedment depth.

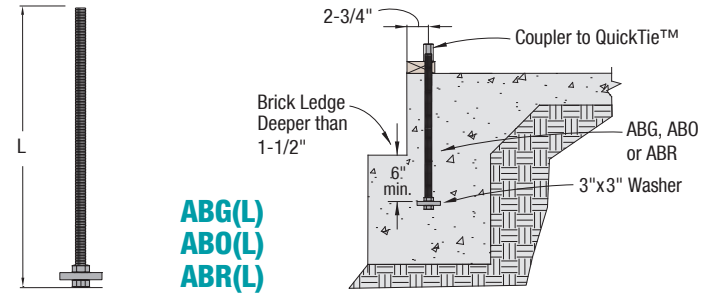

ABG(L)
ABO(L)
ABR(L)

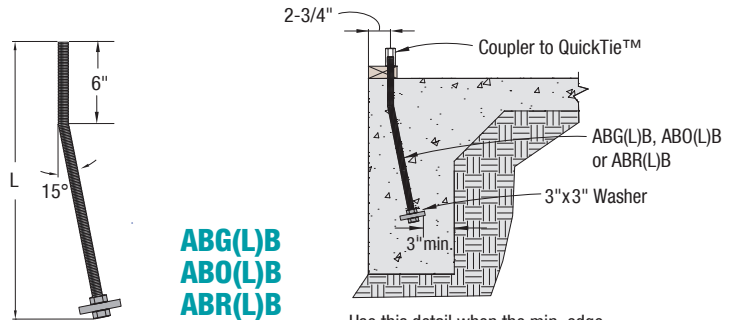

ABG(L)B
ABO(L)B
ABR(L)B

Part No.	Length (L)*	Description
ABG21Z	21"	1/2" Rod, 3" x 3" Washer, Hex Nuts & Coupler
ABG21BZ	21"	1/2" Rod (Bent), 3" x 3" Washer, Hex Nuts & Coupler
ABO21Z	21"	5/8" Rod, 3" x 3" Washer, Hex Nuts & Coupler
ABO21BZ	21"	5/8" Rod (Bent), 3" x 3" Washer, Hex Nuts & Coupler
ABO21BZ-NC	21"	5/8" Rod (Bent), HFL, 3" x 3" Washer, Hex Nuts & Coupler
ABR21Z	21"	3/4" Rod, 3" x 3" Washer, Hex Nuts & Coupler
ABR21BZ	21"	3/4" Rod (Bent), 3" x 3" Washer, Hex Nuts & Coupler
ABR24Z	24"	3/4" Rod, 3" x 3" Washer, Hex Nuts & Coupler
ABR24BZ	24"	3/4" Rod (Bent), 3" x 3" Washer, Hex Nuts & Coupler

ANCHOR BOLT ASSEMBLY (ABA)

PRODUCT FEATURES:

Anchor Bolt Assembly (ABA) holds the anchor in place before pouring the concrete for both concrete slab/foundation and CMU wall applications (coupling application for QT cables).

ASSEMBLY:

Hole Form Locator - 20 Gauge, Galvanized (G90)

Threaded Rod - ASTM A36 Steel, Zinc Plated

Hex Nut - Grade 2, Zinc Plated

Couplers - Grade 2, Zinc Plated

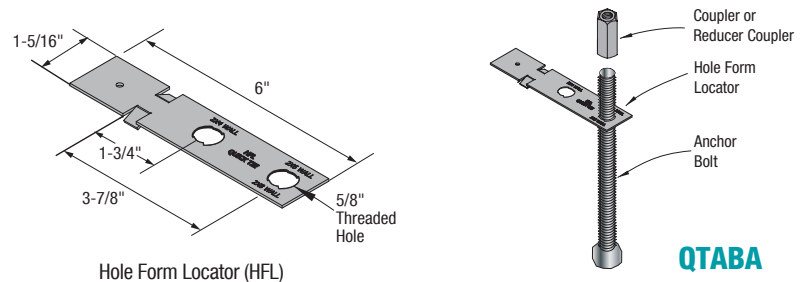

QTABA

Part No.	Description
QTABA-Blue	Hole Form Locator, 5/8" Anchor Bolt & Reducer Coupler
QTABA-Green	Hole Form Locator, 5/8" Anchor Bolt & Reducer Coupler
QTABA-Orange	Hole Form Locator, 5/8" Anchor Bolt & Coupler
QTABA-Red	Hole Form Locator, 5/8" Anchor Bolt & Reducer Coupler

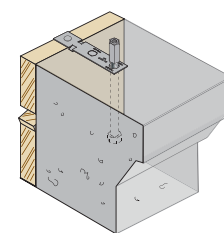

*Other lengths available upon request

FOUNDATION ANCHOR STRAP (FASA)

PRODUCT FEATURES:

Foundation Anchor Strap (FASA4) is a cast-in-place connector designed for use as an alternative to anchor bolts. Each FASA4 strap has one end that is embedded into the concrete foundation. The other end extends above concrete foundation and is field bent over nominal 2x sill plates (with both legs bent around sill plate). Alternatively, one leg may be bent over the sill plate while the other leg is secured vertically over an adjacent stud.

MATERIAL:

FASA4 – 16 ga

COATING:

Galvanized (G185)

INSTALLATION:

- Use all specified fasteners in schedule to achieve values indicated.

CODE COMPLIANCE:

TER 0910-01, FL 3557

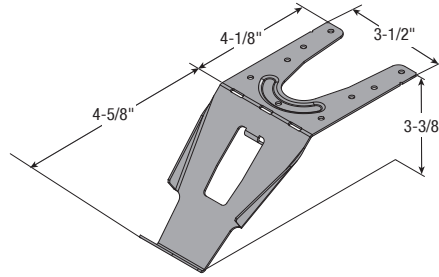

FASA

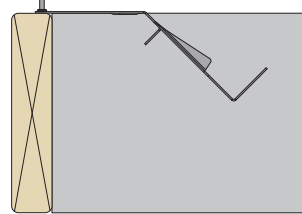
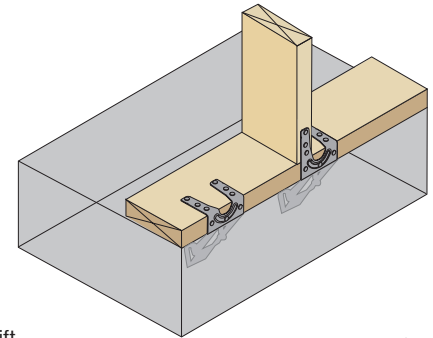

Installation for inside of wall

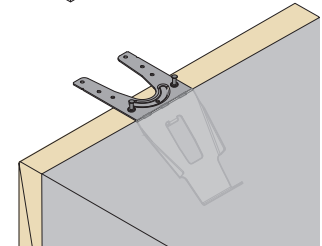
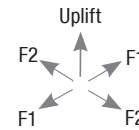

Installation for sill plate and studs

FASA4 ALLOWABLE TENSION AND SHEAR VALUES (ASD) – CONCRETE AND WOOD

Part No.	Installation Type ⁸	Fasteners				Allowable Loads (lb) ^{1,3,4,5}					
		Type	Sill Plate ²		Stud	Wind and Seismic Design Category (SDC) A-B			Seismic Design Category (SDC) C-F		
			Narrow Face	Wide Face		Uplift	F1 Parallel to Wall	F2 Perpendicular to Wall	Uplift	F1 Parallel to Wall	F2 Perpendicular to Wall
FASA4	Standard	10d x 1-1/2" (0.148 x 1.50")	3	6	-	1,310	1,620	1,250	1,150	1,360	1,190
	One Leg Up		3	3	3	1,050	1,260	1,135	920	1,100	1,135

NOTES:

1. Allowable loads are provided for a load duration factor (C_D) of 1.6. No further increase is permitted.
2. Foundation plates or sills shall be pressure-preservative treated Southern Pine (PPT-SP) and shall comply with IBC Section 2304.3.1 and IRC Section R403.1.6.
3. Allowable loads are only applicable to uncracked concrete and are based on a minimum stem wall thickness of 6", minimum distance from the end of the concrete stem wall to the center line of the FASA4 anchor of 4".
4. Minimum compressive strength of concrete is 2,500 psi.
5. Wood framing members (studs) with which the connectors are installed, "One Leg Up," shall have a published specific gravity (SG) of 0.55.

EPOXY ANCHORS

PRODUCT FEATURES:

Epoxy Anchors are used as foundation anchors to resist shear and wind uplifts.

ASSEMBLY:

Threaded Rod - ASTM A36 Steel, Zinc Plated

Hex Nut - Grade 2, Zinc Plated

Square Washer - ASTM A653 Grade 33 or A36 steel, Galvanized (G60 or better), Zinc Plated or GEOMET[®] (Superior to HDG).

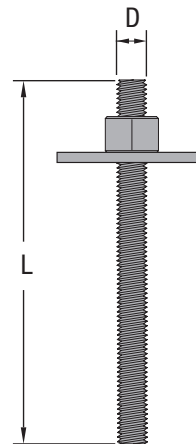

EA

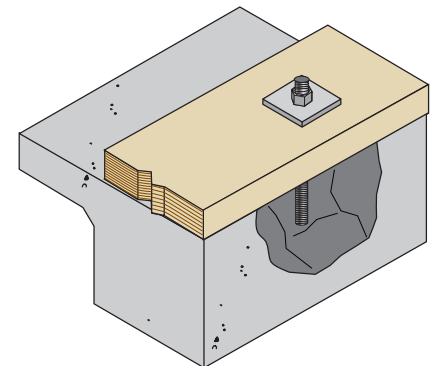

Part No.	Rod Size (D)	Length (L)*	Description
EA.5x6NS	1/2"	6"	1/2"x 6" Threaded Rod, Hex nut and 2 x 2 Galvanized (G185) washer
EA.5x6NS (3x3GE0)	1/2"	6"	1/2"x 6" Threaded Rod, Hex nut and 3 x 3 GEOMET [®] washer
EA.5x6NS (3x3Z)	1/2"	6"	1/2"x 6" Threaded Rod, Hex nut and 3 x 3 Zinc Plated (G60) washer
EA.5x8NS	1/2"	8"	1/2"x 8" Threaded Rod, Hex nut and 2 x 2 Galvanized (G185) washer
EA.625x6NS	5/8"	6"	5/8"x 6" Threaded Rod, Hex nut and 2 x 2 Galvanized (G185) washer
EA.625x8NS	5/8"	8"	5/8"x 8" Threaded Rod, Hex nut and 2 x 2 Galvanized (G185) washer

*Other sizes and lengths available upon request

Epoxy Adhesives and Accessories

QUICKTIE™ EPOXY – QE-1

PRODUCT FEATURES:

QuickTie™ QE-1 adhesives are an injectable two-component adhesive, tested to meet IBC requirements for both cracked and uncracked concrete applications. QE-1 adhesives are used for multiple anchoring systems, including QuickTie™ cables, fractional and metric threaded rod and rebar applications.

CODE COMPLIANCE:

ICC-ESR 4467

Part No.	Description	Standard Box Package
QE-1*	Quick Set Anchoring Epoxy - 19.8 oz	6
QE-1TL**	High Performance Manual Tool (19.8 oz)	1
1BSH	Epoxy Hole Cleanout Brush	1

* One mixing nozzle is packaged with each cartridge. QE-1 & QE-2 mixing nozzles must be used to ensure complete and proper mixing of the adhesive.

** For pneumatic or cordless, battery operated dispensing tools, contact QuickTie™ for ordering information.



ESR-4467
(QE-1 Adhesive Anchoring System)



QE-1 (19.8 OZ.)

QE-1TL (19.8 OZ.)

1BSH

QE-1 NOZZLE

FSTHD SERIES

PRODUCT FEATURES:

The FSTHD and FSTHDJ series are embedded foundation strap-tie holdowns engineered to anchor wood framing (studs or posts) securely to concrete foundations or slabs. These holdowns are typically used at the ends of shear walls or in other high-stress framing locations where resisting uplift forces is critical.

MATERIAL:

FSTHD8/8J – 14 ga
FSTHD10/10J, 14/14J – 12 ga

COATING:

Galvanized (G185)

INSTALLATION:

- Use all specified fasteners in schedule to achieve values indicated.

CODE COMPLIANCE:

TER 0910-01; FL 3557

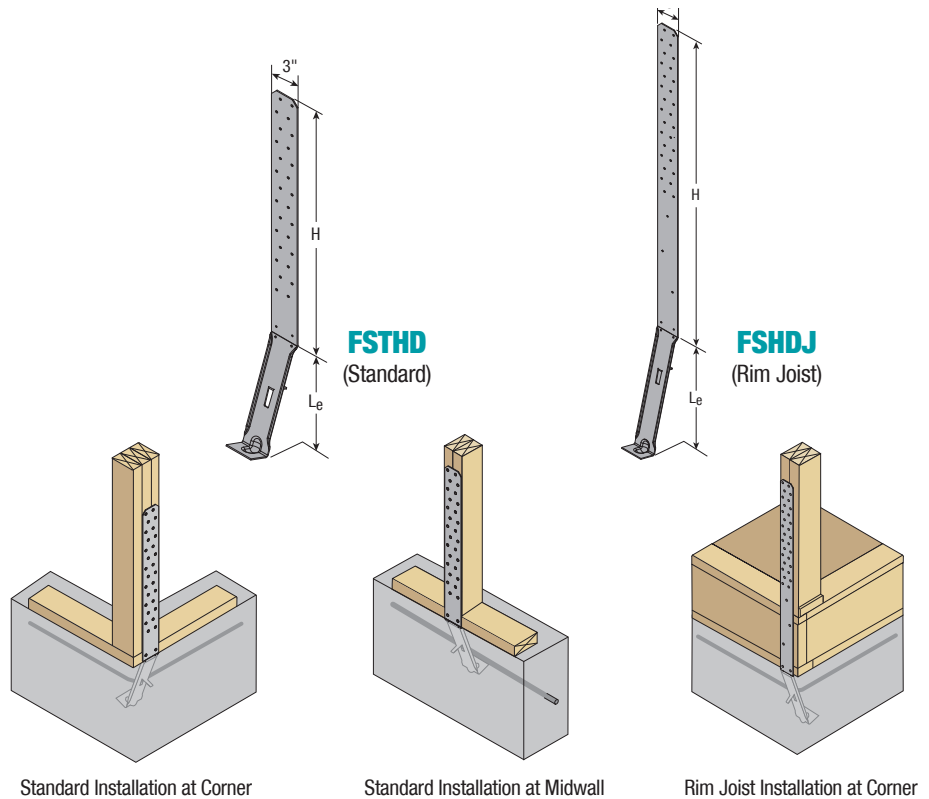

Standard Installation at Corner

Standard Installation at Midwall

Rim Joist Installation at Corner

ALLOWABLE LOADS FOR FOUNDATION STRAP-TIE HOLDOWNS (LB)^{1,2,3,4,5}

Part No.	Embedment Length, L_e (in.)	Strap Length, H (in.)	Stud Fasteners		SP		DF-L		HF/SPF	
			Type	Qty	Corner ⁴	Mid-Wall ⁵	Corner ⁴	Mid-Wall ⁵	Corner ⁴	Mid-Wall ⁵
					1.6	1.6	1.6	1.6	1.6	1.6
FSTHD8	8	18-5/8	10d x 3-1/4" (0.148 x 3.25")	20	2,755	3,455	2,755	3,195	2,755	2,760
FSTHD8J		32-1/8								
FSTHD10	10	24-5/8								
FSTHD10J		38-1/8								
FSTHD14	14	26-1/8								
FSTHD14J		39-5/8								

NOTES:

1. Allowable loads are provided for a load duration factor (C_D) of 1.6. No further increase is permitted. Total deflection of connector assembly at highest allowable load: FSTHD8 = 0.072", FSTHD10 = 0.068", FSTHD14 = 0.111"
2. Minimum wood member size is 3" x 3-1/2".
3. Minimum compressive strength of concrete is 2,500 psi. Minimum of one (1) #4 rebar is required at 6" embedment and 3" edge distance.
4. For corner straps, minimum end distance is 1/2" and minimum center-to-center spacing is 3 times the embedment length.
5. For mid-wall straps, end distance is 1.5 times the embedment length.

Post Base Anchors



PORCH POST BASE ANCHORS (PBA-P)

PRODUCT FEATURES:

Porch Post Base Anchors (PBA-P) are used to attach the base of a wood post to a concrete foundation. These anchors are designed to withstand vertical construction loads prior to pouring of concrete and to support permanent porch framing throughout all stages of construction.

MATERIAL:

PBA-P Strap & SO – 12 Gauge

COATING:

Galvanized (G185)



INSTALLATION:

- Use all specified fasteners in schedule to achieve allowable load values.
- The designer or specifier shall check the requirements and capacity of wood post and concrete for resisting gravity and uplift loads.
- Nails (10d common) and concrete screws are NOT included.
- Clean surface, place Post Base Porch Strap in position and install the screws per manufacturer's installation procedures.
- Insert the stand-off plate over the strap and position the wood post on top.
- Attach Post Base Porch Strap to wood post using 10d common nails on both sides

CODE COMPLIANCE:

TER 0910-01; FL 3557

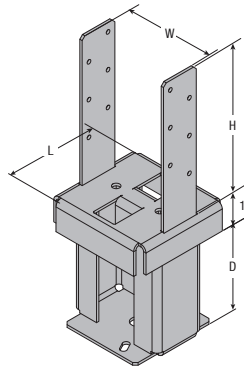

PBA44-4P/6P
PBA66-4P/6P

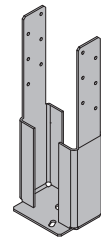

STRAP

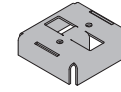

STAND-OFF (SO)

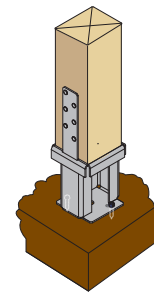

Prior to Concrete Pour

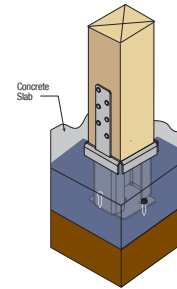

Embedded in Concrete

ALLOWABLE LOADS FOR PORCH POST BASE ANCHORS, LB (PBA-P)^{1,2,3}

Part No.	Strap Dimensions (in.)				Steel Thickness (Gauge)		Fasteners		SP (0.55) / DF-L (0.50)			
	Width	Length	Height	Depth	Strap	Stand-Off	Post		Prior to Concrete Pour		Embedded in Concrete	
							Qty	Size	Bearing	Uplift	Bearing	Uplift
PBA44-4P	3-5/8	3-5/8	5-7/8	4	12	12	12	10d	7,900	440	7,900	2,700
PBA44-6P				6								
PBA66-4P	5-5/8	5-5/8	5-5/8	4	12	12	12	10d	12,775	440	12,775	2,700
PBA66-6P				6								

NOTES:

1. Use two (2) 1/4" x 1-1/2" concrete screws to install prior to concrete pour. Minimum allowable pullout is 220 lb per screw with minimum edge and spacing of 2-1/2".
2. Allowable load values provided are for wet service condition, no further reduction required.
3. Minimum concrete compressive strength shall be 2,500 psi. Concrete design shall be performed by others.

PAS SERIES

PRODUCT FEATURES:

QuickTie™ Purlin Anchor Straps (PAS) are used for joist to concrete or CMU wall attachment and foundation applications.

MATERIAL:

PAS Series - 12 Gauge

COATING:

Galvanized (G185)



INSTALLATION:

- Use all specified fasteners in schedule to achieve the values indicated.
- PAS Series requires a minimum of 4" and 6" embedment into the concrete and CMU walls, respectively.
- Minimum concrete compressive strength is 2,500 psi.

CODE COMPLIANCE:

TER 0910-01; FL 3557

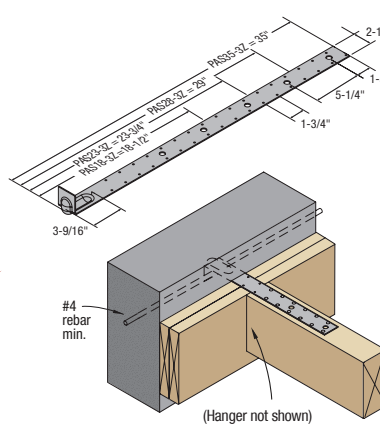

Purlin-to-Wall Attachment

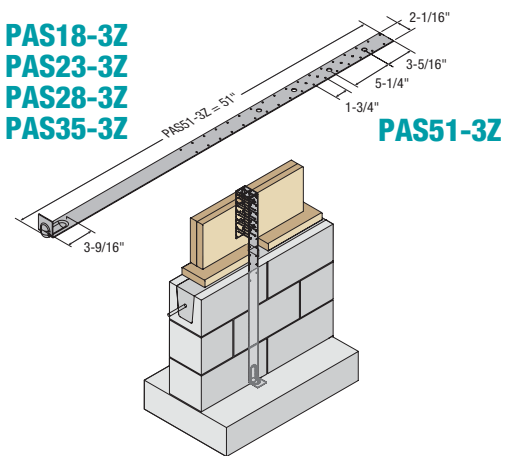

Rim Joist-to-CMU Stem Wall Attachment

ALLOWABLE TENSION LOADS FOR PURLIN ANCHORS (LB)¹

Part		Embedment Length, L _e (in.)		Stud Fasteners		Allowable Loads (lb) ^{1,4}			
						SP / DF-L (SG = 0.50)		HF / SPF	
						Floor	Uplift	Floor	Roof
No.	Length, L (in.)	Concrete ²	CMU ³	Type	Qty	1.0	1.6	1.0	1.6
PAS18-3Z	18-1/2	4	6	10d (0.148 x 3")	12	1,685	2,700	1,465	2,340
PAS23-3Z	23-3/4				16	2,250	3,600	1,950	3,120
PAS28-3Z	29				16	2,250	3,600	1,950	3,120
PAS35-3Z	35				16	2,250	3,600	1,950	3,120
PAS51-3Z	51				10	1,405	2,250	1,220	1,950

NOTES:

1. Minimum wood member size is 3" x 31/2".
2. Minimum compressive strength of concrete is 3,000 psi.
3. Minimum compressive strength of grout-filled CMU is 2,000 psi.
4. Total deflection of connector assembly at highest allowable load is 0.031".

Purlin Anchor Straps

EMBEDDED TRUSS ANCHOR STRAPS (METAS/HETAS)

PRODUCT FEATURES:

QuickTie™ Embedded Truss Anchor Straps (METAS/HETAS) are used for roof truss to concrete or CMU wall attachments.

MATERIAL:

METAS Series - 18 Gauge
HETAS Series - 16 Gauge

COATING:

Galvanized (G185)

INSTALLATION:

- Use all specified fasteners in schedule to achieve the values indicated.
- METAS/HETAS Series requires a minimum of 4" embedment into the concrete and CMU walls.

CODE COMPLIANCE:

TER 0910-01; FL 3557

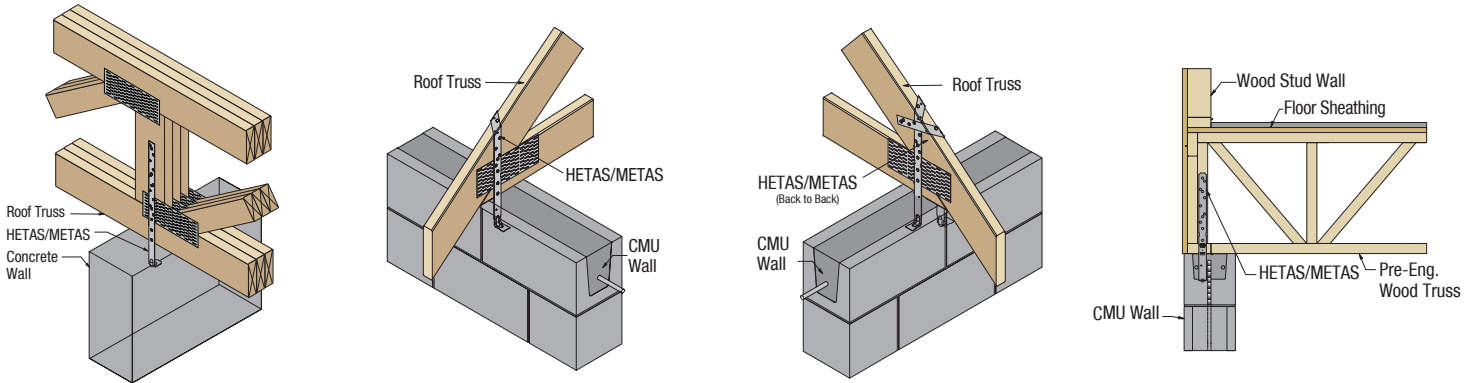
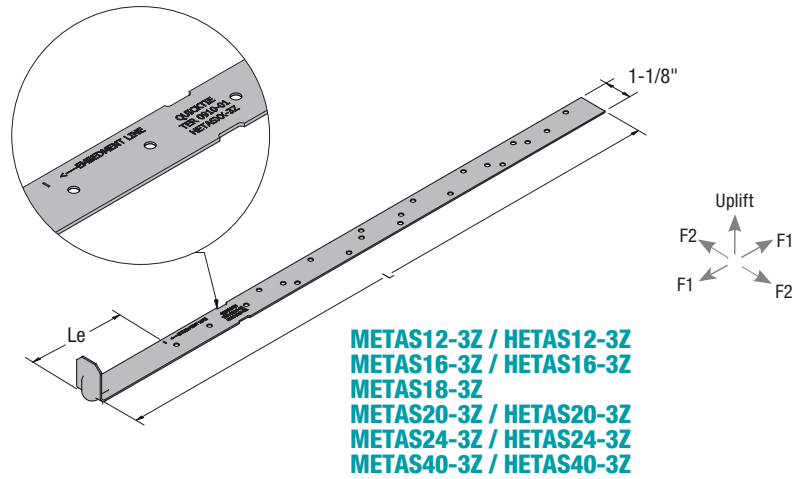

ALLOWABLE LOADS FOR EMBEDDED TRUSS ANCHOR STRAPS (LB)^{1,2,3,4,5}

Part No.	Length, L (in.)	Embed Length, L _e (in.)		Fasteners		Allowable Loads (LB) - Southern Pine (SG = 0.55, C _D = 1.6)											
						Single Anchor						Double Anchor					
		Concrete	CMU	Qty	Nail Type	CMU			Concrete			CMU			Concrete		
						Uplift	F1	F2	Uplift	F1	F2	Uplift	F1	F2	Uplift	F1	F2
METAS12-3Z	12	4	4	7	10dx1-1/2 (0.148 x 1.5")	1,445	340	760	1,445	340	760	2,890	1,335	1,140	2,890	1,335	1,140
METAS16-3Z	16					1,600	440	760	1,600	440	760	3,195	1,375	1,140	3,195	1,375	1,140
METAS18-3Z	18					1,475	340	760	1,475	340	760	2,950	1,335	1,140	2,950	1,335	1,375
METAS20-3Z	20					1,895	440	760	1,895	440	760	3,325	1,375	1,140	3,175	1,405	1,375
METAS24-3Z	24																
METAS40-3Z	40																

NOTES:

1. Allowable loads are provided for load duration factor (C_D) of 1.6. No further increase is permitted.
2. Minimum specified compressive strength of grout is 2,000 psi and minimum edge distance for CMU installation is 2 in.
3. Minimum specified compressive strength of concrete is 2,500 psi and minimum edge distance for concrete installation is 1.5".
4. Loading in F1 direction indicates shear forces parallel to the plane of the concrete/CMU wall.
5. Loading in F2 direction indicates shear forces perpendicular to the plane of the concrete/CMU wall.

QR CODES

(Open your camera application to scan and view)

INSTALLATION VIDEOS



SPArTan™ Installation



Form Tie Installation

CODE APPROVALS



TER 0910-01
(QuickTie™ Systems-Wood & QuickTie™ Connectors)



TER 1404-06
(QuickTie™ Systems-Masonry)



ESR-4467
(QE-1 Adhesive Anchoring System)



We Sell
NATIONWIDE



★ HEADQUARTERS
■ PROJECTS



Quick Tie Products, Inc.
quicktie.com

MAIN OFFICE:
13300 Vantage Way
Jacksonville, FL 32218
Phone: (904) 281-0525
To Order: orders@quicktieproducts.com

©Copyright 2026 Quick Tie Products, Inc.
Rev. 3/2/26



MADE IN USA